

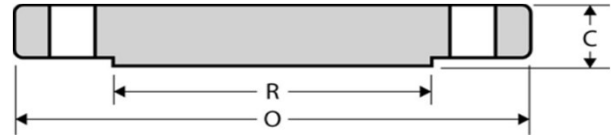

Blind Flange

CLASS 150, 304 Stainless Steel

Inches / Pounds



Part #	Nominal Pipe Size	Outside Diam. Of Flange (O)	Thick. Of Flange (C)	Diam. Of Raised Face (R)	No. of Holes	Diam. Of Holes	Diam. Of Bolts	Diam. Of Bolt Circle	Approximate Weighth (in Lbs.)
KFBL.25S	1/2	3.50	0.44	1.38	4	0.62	0.50	2.38	1
KFBL.75S	3/4	3.88	0.50	1.69	4	0.62	0.50	2.75	2
KFBL1S	1	4.25	0.56	2.00	4	0.62	0.50	3.12	2
KFBL1.25S	1 1/4	4.62	0.62	2.50	4	0.62	0.50	3.50	3
KFBL1.5S	1 1/2	5.00	0.69	2.88	4	0.62	0.50	3.88	4
KFBL2S	2	6.00	0.75	3.62	4	0.75	0.62	4.75	5
KFBL2.5S	2 1/2	7.00	0.88	4.12	4	0.75	0.62	5.50	7
KFBL3S	3	7.50	0.94	5.00	4	0.75	0.62	6.00	9
KFBL3.5S	3 1/2	8.50	0.94	5.50	8	0.75	0.62	7.00	13
KFBL4S	4	9.00	0.94	6.19	8	0.75	0.62	7.50	17
KFBL5S	5	10.00	0.94	7.31	8	0.88	0.75	8.50	20
KFBL6S	6	11.00	1.00	8.50	8	0.88	0.75	9.50	26
KFBL8S	8	13.50	1.12	10.62	8	0.88	0.75	11.75	45
KFBL10S	10	16.00	1.19	12.75	12	1.00	0.88	14.25	70
KFBL12S	12	19.00	1.25	15.00	12	1.00	0.88	17.00	110

* Dimensions conform to ASME B16.5

* Material conforms to ASTM SA182 Grade F304/304L